

EASTMAN OFFICE CENTER

Suite 240 & 250 2,790 SF Second Floor

651 OLD MOUNT PLEASANT AVE • LIVINGSTON, NJ



BUILDING FEATURES

- 50,000 square feet in two-story office building
- Card access after regular business hours
- After hours visitor's call box
- Outdoor seating
- On-site cafe
- Immediate access to I-280 and Route 10
- Newly Upgraded Lobbies
- Conference Center

For more info eastmanofficecenter.com

EASTMAN OFFICE CENTER

Suite 240 & 250 2,790 SF Second Floor

651 OLD MOUNT PLEASANT AVE • LIVINGSTON, NJ

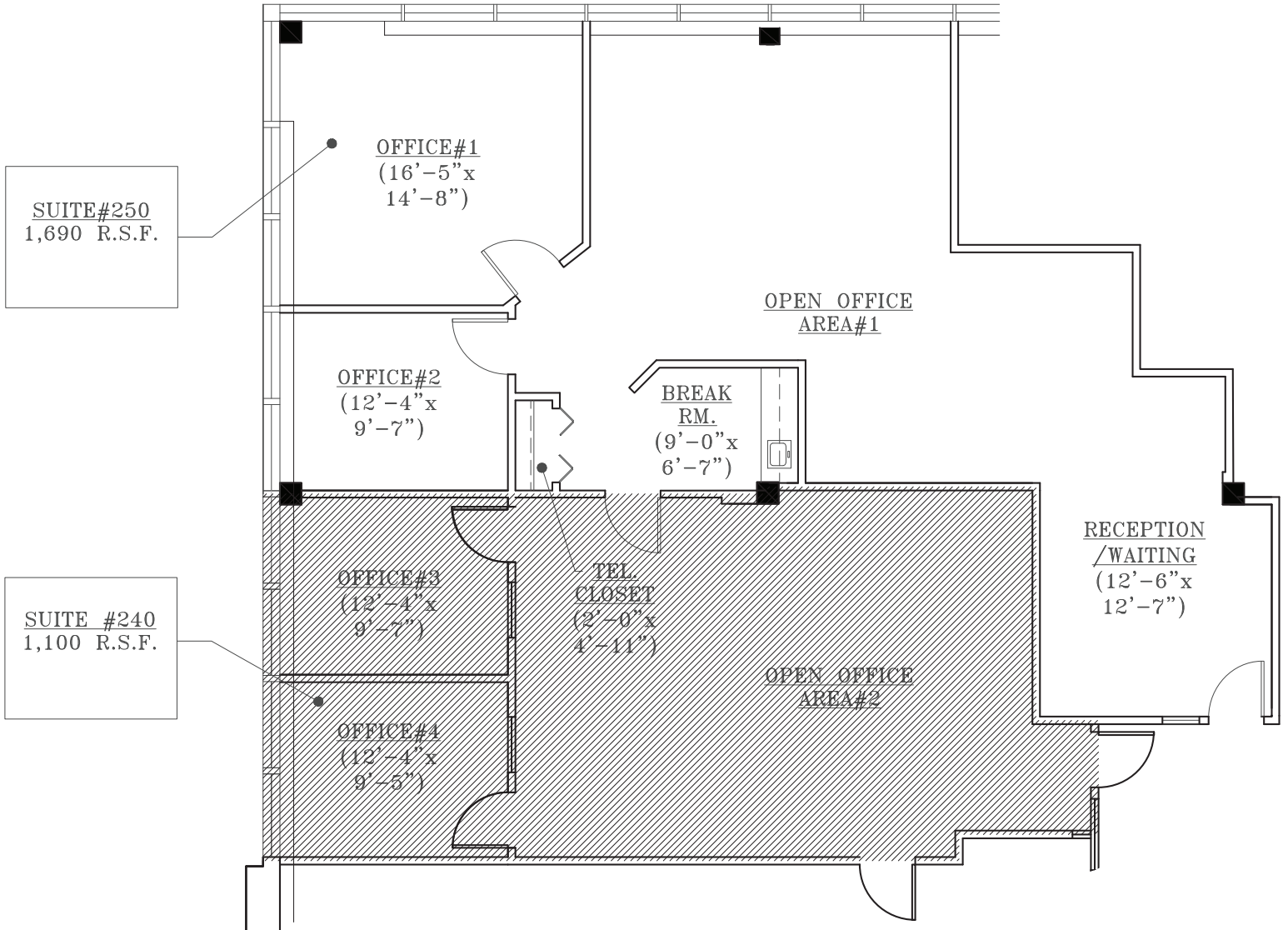

No warranty or representation / subject to errors or omissions.



Eric J. Maurer
973.488.6110
ericm@eastmancompanies.com

Jonathan Meisel
732-509-2843
jonathan.meisel@cbre.com



For more info eastmanofficecenter.com